

## 1 Bedroom Apartment for Rent - £850 per month

Navigation Street, Birmingham, B5 4AB



### KEY FEATURES:

- LARGE ONE BEDROOM APARTMENT
- CENTRAL LOCATION
- FULLY FITTED KITCHEN
- FAMILY BATHROOM
- 24 HOUR CONCIERGE
- MINUTE'S WALK TO NEW STREET STATION
- FURNISHED TO A HIGH STANDARD
- ULTRA MODERN FIXTURES AND FITTINGS

## Description

\*\*\*LOCATION LOCATION LOCATION\*\*\*

Beautifully presented large one bedroom apartment in the centrally located Orion Building. The property is situated on an upper floor with lift access. The apartment consists of large open-plan living with fitted appliances, generously large living space which is furnished to a very high standard. The apartment benefits from large floor to ceiling windows allowing a ton of light throughout the apartment. The Orion Building benefits from full time concierge, secure fob entry and lift access.

## Location

Orion Building is sandwiched between The infamous Mailbox and New Street Station, Grand Central. The Bullring, Colmore Row and Brindleyplace are all within a 5-10 minutes' walk from the apartment. With all local amenities on your doorstep, including The Mailbox with all its restaurants, bars and entertainment facilities The Orion Building sets the standard on location when it comes to city centre living.



## Navigation Street, Birmingham, B5

Approximate Area = 612 sq ft / 56.8 sq m

For identification only - Not to scale

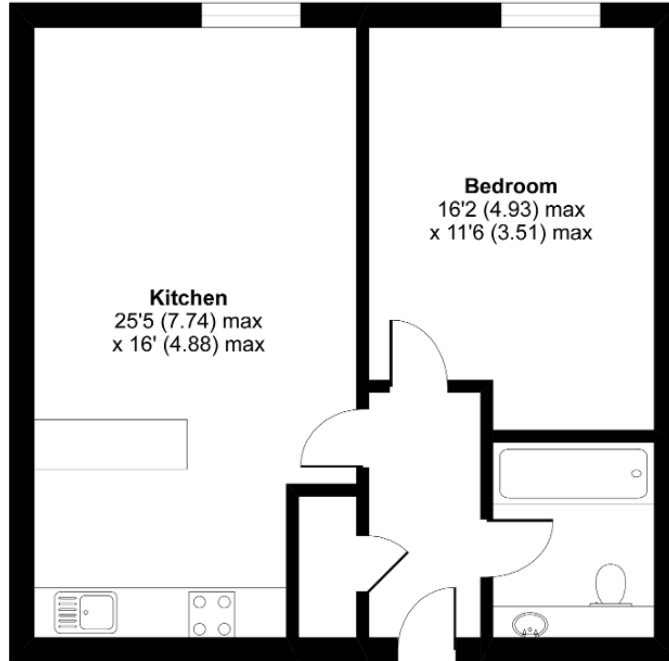

SEVENTH FLOOR



Floor plan produced in accordance with RICS Property Measurement Standards incorporating International Property Measurement Standards (IPMS2 Residential). © nichecom 2020. Produced for Barrows and Forrester Property Group. REF: 602289



**BARROWS  
FORRESTER**  
PROPERTY GROUP

