

2 Bedroom Apartment for Rent - £950 per month

Mint Drive, Hockley, Birmingham, B18 6EB



KEY FEATURES:

- LARGE TWO BEDROOM APARTMENT
- OPEN-PLAN LIVING
- FURNISHED OR UNFURNISHED
- MINUTES' WALK TO CITY CENTRE
- FULLY FITTED KITCHEN
- SECURE DEVELOPMENT
- FAMILY BATHROOM PLUS EN-SUITE
- MINUTES' WALK TO COLMORE ROW

Description

*** STUNNING MODERN TWO BEDROOM APARTMENT ***

Large two bedroom two bathroom apartment located close to Birmingham's famous Jewellery Quarter. The benefits of The Mint include easy access to Birmingham City Centre, security and high quality finish. The actual apartment consists of two generous sized bedrooms, long entrance hall and ultra modern fixtures and fittings. The property can be furnished or unfurnished.

Location

The Mint is located within a 2 minutes' walk of The Jewellery Quarter with tram stops and local public transport all within a 7 minutes' walk. New Street Station is a 15 minutes walk and Snow Hill 10 minutes. 24-hour superstore is a short 2 minutes walk.

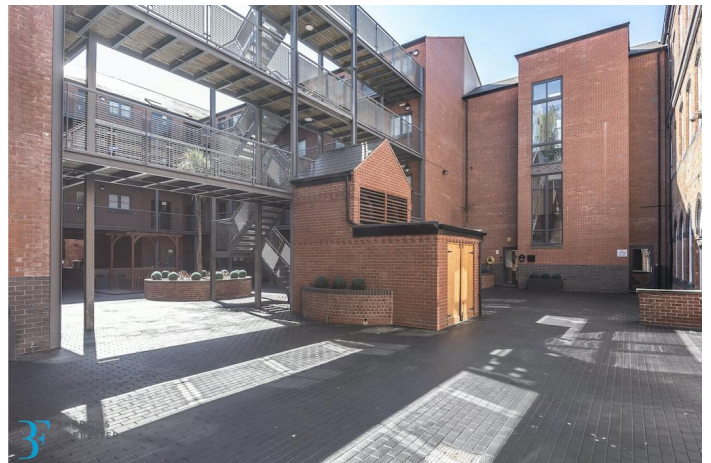

Mint Drive, Hockley, Birmingham, B18

Approximate Area = 696 sq ft / 64.6 sq m

For identification only - Not to scale

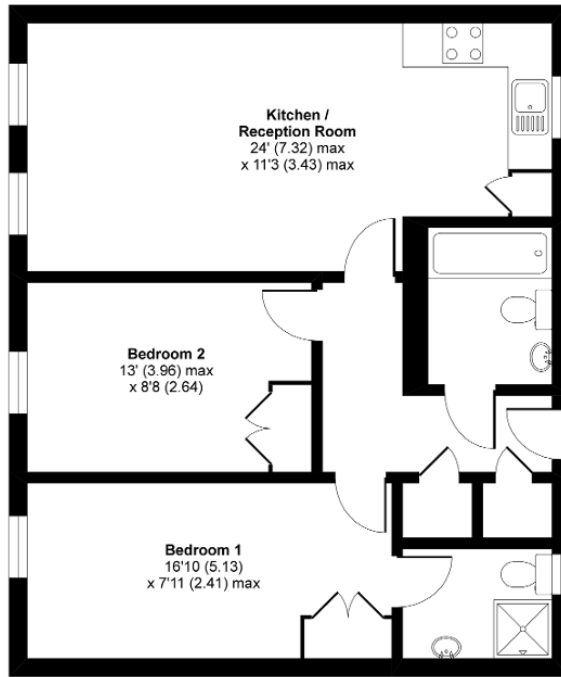

SECOND FLOOR



Floor plan produced in accordance with RICS Property Measurement Standards incorporating International Property Measurement Standards (IPMS2 Residential). © nichecom 2020. Produced for Barrows and Forrester Property Group. REF: 602749



BARROWS FORRESTER
PROPERTY GROUP

Energy Efficiency Rating		Current	Potential
Very energy efficient - lower running costs	(92-100) A		
(81-91) B			
(69-80) C			
(55-68) D			
(39-54) E			
(21-38) F			
(1-20) G			
Not energy efficient - higher running costs			
England, Scotland & Wales		81	84
	EU Directive 2002/91/EC		

Environmental Impact (CO ₂) Rating		Current	Potential
Very environmentally friendly - lower CO ₂ emissions	(92-100) A		
(81-91) B			
(69-80) C			
(50-68) D			
(39-54) E			
(21-38) F			
(1-20) G			
Not environmentally friendly - higher CO ₂ emissions			
England, Scotland & Wales		76	76
	EU Directive 2002/91/EC		